

LEAD-LINED

DECAY CABINET

The Decay Cabinet is designed for long and short term storage of decaying radioactive material. Two adjustable shelves support up to 100 lb each. The door is key-locked to prevent unauthorized access. The cabinet will accommodate sharps containers and other boxed waste prior to disposal. It can also be used to store flood sources.

SPECIFICATIONS:

Dimensions: 30.5" w x 24" d x 36.5" h
(77.5 x 61 x 92.7 cm)

Lead Shielding: .25" (.64 cm), .5" (1.3 cm) or 1"
(2.5 cm) thick on all six sides

Shelf Dimensions: 26" w x 18" depth (66 x 45.7 cm), 100 lb
(5.4 kg) capacity, adjustable height

Door: Key-locked

Countertop: Stainless steel with 4" backsplash and
.5" spill-proof lip

Finish: Durable powder-coat paint

Weight:

- 244-140: 730 lb (331 kg)
- 244-141: 1267 lb (575 kg)
- 244-142: 2341 lb (1062 kg)



- 244-140** Cabinet, Decay, .25" lead \$6,800.00
- 244-141** Cabinet, Decay, .5" lead 8,200.00
- 244-142** Cabinet, Decay, 1" lead 11,000.00

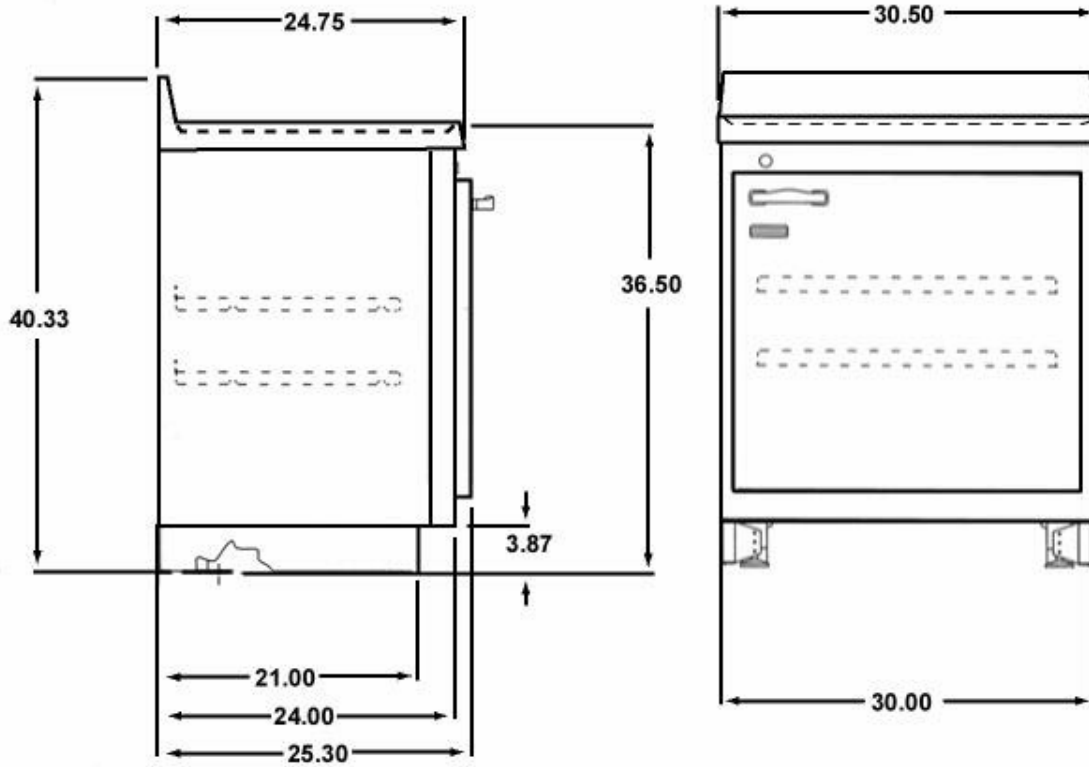

Prices subject to change without notice.

www.jgravengard.com 2007-10-12

J. Gravengard Corporation

Medical Imaging Sales & Service

PO Box 20171 Portland, Oregon 97294 Nationwide (800)796-SCAN

Local (503)255-0535 Fax (503)255-7047