

LEAD-LINED

# SINK AND WASTE CABINET

The Sink and Waste Cabinet performs three functions. A stainless steel sink allows the convenience of running water in the hot lab. The space under the sink is used for cold storage.

Separated from the sink section by a lead barrier, the waste section includes a shielded port that allows waste to be dropped into a polyethylene container for storage until decayed.

**SPECIFICATIONS:**

**Dimensions:** 30.5" w X 24" depth x 36.5" h (77.5 x 61 x 92.7 cm)

**Lead Shielding:** .25" (.64 cm), .5" (1.3 cm) or 1" (2.5 cm) thick on all six sides

**Sink Section:** 10" w x 14" depth x 10" h (25.1 x 35.6 x 25.4 cm)  
Integral stainless steel sink with gooseneck faucet and wrist blades. Suitable for cold storage

**Waste Section:**

**Chute:** 6.5" dia (16.5 cm) w/ .5" thick (1.3 cm) lead shielded cover

**Container:** I.D.: 20.5" h x 11.25" dia (52 x 25.6 cm), polyethylene, 7 gal capacity

**Door:** Key-locked

**Countertop:** Stainless steel with 4" backsplash and .5" spill-proof lip

**Finish:** Durable powder-coat paint

**Weight:**

244-130: 750 lb (341 kg)

244-131: 1253 lb (569.5 kg)

244-132: 2260 lb (1027.3 kg)



**244-130** Cabinet, Sink and Waste, .25" lead. \$7,300.00

**244-131** Cabinet, Sink and Waste, .5" lead .... 8,700.00

**244-132** Cabinet, Sink and Waste, 1" lead ... 12,000.00

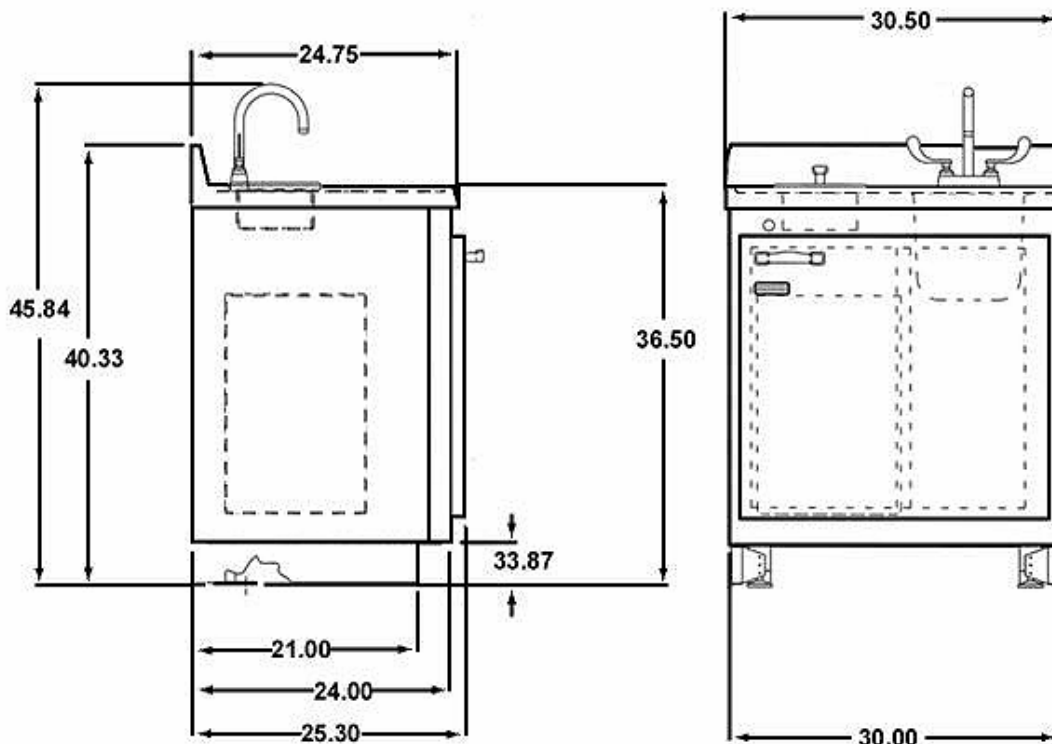

Prices subject to change without notice.

[www.jgravengaard.com](http://www.jgravengaard.com) 2007-10-12

**J. Gravengaard Corporation**

Medical Imaging Sales & Service

PO Box 20171 Portland, Oregon 97294 Nationwide (800)796-SCAN

Local (503)255-0535 Fax (503)255-7047